



Lampada a plafone a doppia accensione. Montatura in metallo verniciato bianco. Diffusore in vetro soffiato bianco opalino acidato.

## Amélie

3631BI	1x150W E27 (IN) + 1x22W 2GX13 (FL)
3631/1BI	1x200W E27 (IN) + 1x55W 2GX13 (FL)

CE Classe # IP20

Ceiling lamp with double switching. White painted metal mounting. Diffuser in white opal acid-etched blown glass.

Plafonnier. Possibilité de double allumage. Structure en métal verni blanc. Diffuseur en verre soufflé blanc opalin traité avec l'acide.

Deckenlampe mit Möglichkeit der Doppelschaltung. Struktur aus weißem lackiertem Metall. Schirm aus weißem, geätztem mundgeblasem Opalglas.



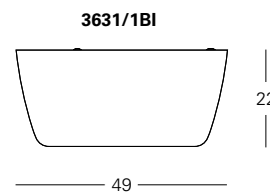
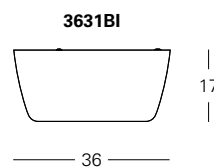

Lámpara de plafón con posibilidad de doble encendido. Montura en metal pintado blanco. Difusor de cristal soplado blanco opalino tratado al acido.

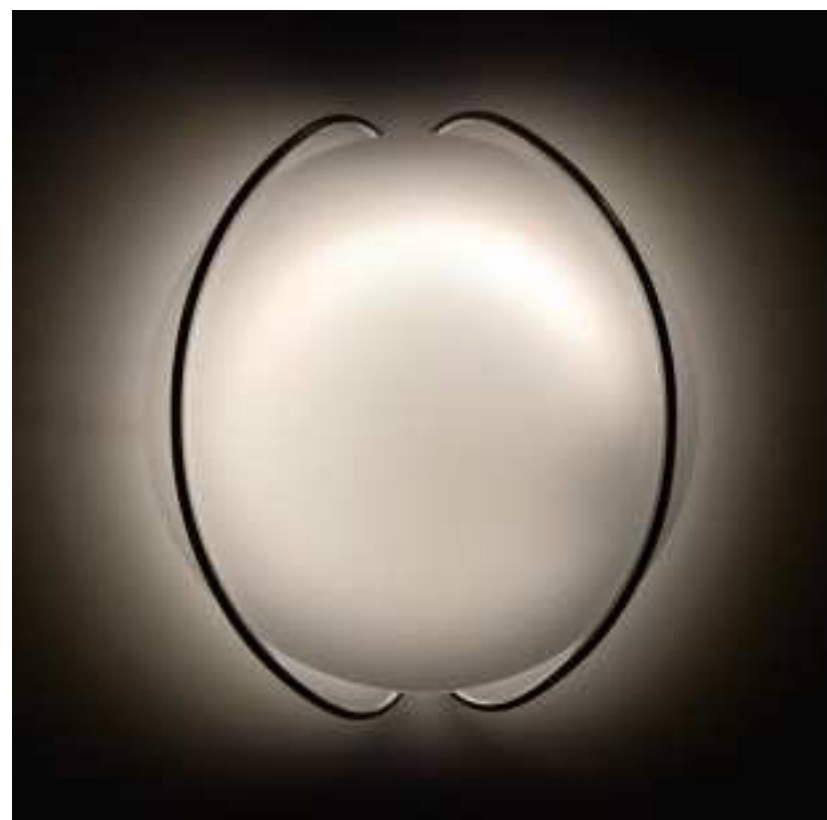

Lampada a plafone.  
Diffusore in vetro  
soffiato bianco satinato.  
Montatura in metallo  
cromato. Di facile  
manutenzione,  
è disponibile in due  
dimensioni e con  
sorgente luminosa  
fluorescente o alogena.

## Iris



3833	 1x22W 2GX13 (FL)
3833/1	 1x55W 2GX13 (FL)
3834	 3x40W G9 (HA)
3834/1	 3x75W G9 (HA)

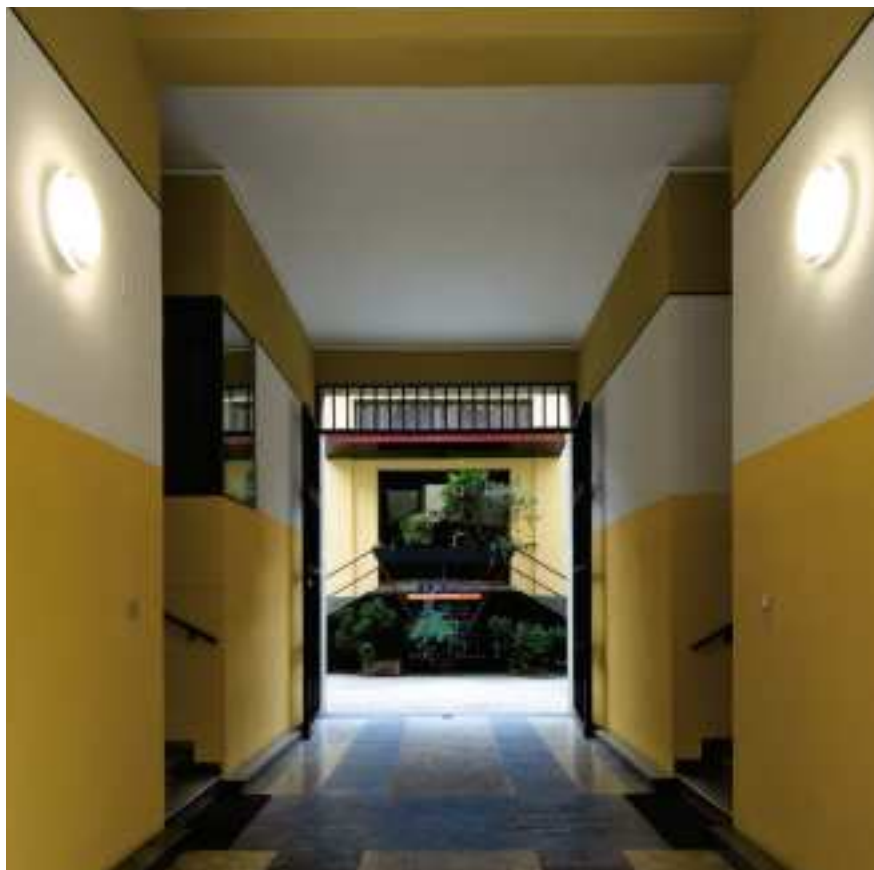

Lampada da parete o plafone. Montatura in metallo verniciato bianco. Diffusore in polimetilmetacrilato.

# Lunapiena

5383

1x55W 2GX13 (FL)

CE *Classe I* IP20

Wall or ceiling lamp. White painted metal structure. Diffuser in polymethacrylate.

Applique ou plafonnier. Structure en métal verni blanc. Diffuseur en polyméthacrylate.

Wand- oder Deckenlampe. Struktur aus weißem lackiertem Metall. Schirm aus Polymethacrylat.

Lámpara de pared o plafón. Estructura de metal pintado blanco. Difusor de polimetilmetacrilato.

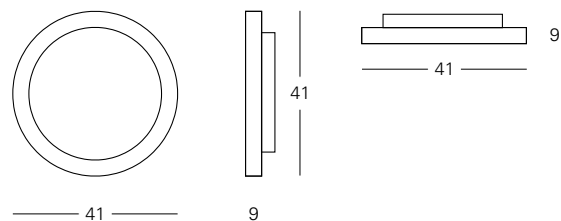

Lampada da parete  
o da plafone.  
Montatura in metallo  
cromato. Diffusore  
in vetro stampato.

## Maristella



3110VST/CR		1x18W 230V 2G11 (FL)
3111VST/CR		2x25W 230V E14 (IN)
3112VST/CR		1x24W 230V 2G11 (FL)
3113VST/CR		2x40W 230V E14 (IN)
3114VST/CR		1x36W 230V 2G11 (FL)
3115VST/CR		3x40W 230V E14 (IN)

   Classe I IP44

Wall or ceiling lamp.  
Chrome-plated metal frame.  
Diffuser in printed glass.

Applique ou plafonnier.  
Monture en métal chromé.  
Diffuseur en verre imprimé.

Wand- oder Deckenlampe.  
Gestell aus verchromtem Metall.  
Schirm aus gedrucktem Glas.

Lámpara de pared o plafón.  
Estructura de metal cromado.  
Difusor de cristal grabado.

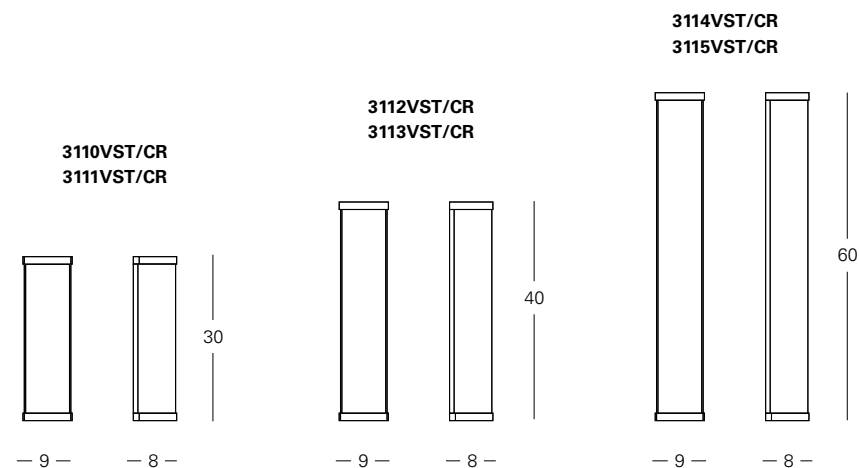

Cinema Odeon - Milano (I)



2775/2G - 2775/5G - 2775/7G  
2775/7/23G

Lampada da parete o plafone a bassa tensione (2775/2G, /5G, /7G) e a tensione di rete (2775/7/23G). Montatura in tecnopolimero a elevata resistenza termica. Diffusore in vetro sabbato termoresistente.

2969/2G - 2969/5G

Lampada da incasso per parete o plafone a bassa tensione. Montatura in tecnopolimero a elevata resistenza termica. Diffusore in vetro sabbato termoresistente.

## Sillaba



Teatro Civico - Tortona (I)

2775/2G	1x20W 12V G4 (HA)
2775/5G	1x50W 12V GY6,35 (HA)
2775/7G	1x75W 12V GY6,35 (HA)
2775/7/23G	1x60W 230V G9 (HA)
2969/2G	1x20W 12V G4 (HA)
2969/5G	1x50W 12V GY6,35 (HA)

2775/7 Classe III IP40
 

 2775/7/23G Classe III IP40
 

 2775/2G - 2775/5G Classe III IP44
 

 2969/2G - 2969/5G Classe III IP20

**2775/2G - 2775/5G - 2775/7G**  
**2775/7/23G** Wall or ceiling lamp at low voltage (2775/2G, /5G, /7G) and at main voltage (2775/7/23G). Heat-resistant mounting in technopolymer. Diffuser made of high-resistant sandblasted glass.

**2969/2G - 2969/5G** Recessed lamp for wall and ceiling at low voltage. Mounting in high heat-resistant technopolymer. Shade in heat-resistant sandblasted glass.

**2775/2G - 2775/5G - 2775/7G**  
**2775/7/23G** Applique ou plafonnier à bas voltage (2775/2G, /5G, /7G) ou à tension réseau (2775/7/23G). Monture en technopolymère à résistance thermique élevée. Diffuseur en verre sablé thermorésistant.

**2969/2G - 2969/5G** Lampe à encastrer dans le mur ou au plafond, à bas voltage. Monture en technopolymère à résistance thermique élevée. Diffuseur en verre sablé thermorésistant.

**2775/2G - 2775/5G - 2775/7G**  
**2775/7/23G** Wand-oder Deckenlampe für Niederspannung (2775/2G, /5G, /7G) oder Netzspannung (2775/7/23G). Gestell aus hoch hitzebeständigem Technopolymer. Schirm aus hitzebeständigem sandgestrahltem Glas.

**2969/2G - 2969/5G** Einbauleuchte für Wand und Decke für Niederspannung. Gestell aus hoch hitzebeständigem Technopolymer. Schirm aus hitzebeständigem sandgestrahltem Glas.

**2775/2G - 2775/5G - 2775/7G**  
**2775/7/23G** Lámpara de pared o plafón de baja tensión (2775/2G, /5G, /7G) o de tensión de red (2775/7/23G). Montura en tecnopolímero de elevada resistencia térmica. Difusor de cristal arenado termoresistente.

**2969/2G - 2969/5G** Lámpara empotrable para pared y plafón de tensión baja. Montura en tecnopolímero de elevada resistencia térmica. Difusor de cristal arenado termoresistente.

2775/2G

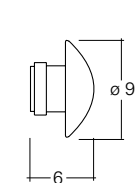

2775/5G

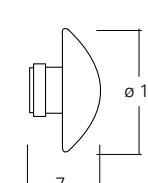

2775/7G

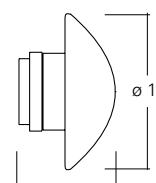

2775/7/23G

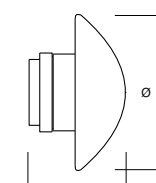

2969/2G

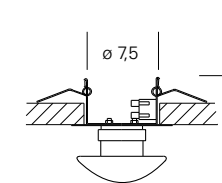

2969/5G

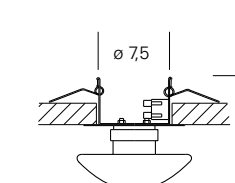

Piero Castiglioni ■ 1988



Lampada da parete o  
plafone. Montatura in  
metallo verniciato grigio.  
Diffusore in vetro  
sabbato termoresistente.

## Sillabone

2793G  1x100W 230V E27 (HA)

    Classe I IP20

Wall or ceiling lamp.  
Grey painted metal structure.  
Heat-resistant sandblasted  
glass diffuser.

Applique murale ou plafonnier.  
Structure en métal verni  
gris. Diffuseur en verre sablé  
thermorésistant.

Wand- oder Deckenlampe. Struktur  
aus grauem lackiertem Metall.  
Schirm aus hitzebeständigem sand-  
gestrahltem Glas.

Lámpara de pared o plafón.  
Estructura en metal barnizado  
gris. Difusor en cristal arenado  
termorresistente.

